

align wall unit

Assembly instructions.



You have received:



Wall Unit Top

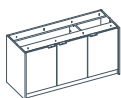

Wall Unit Base



4 x Cams
(pre-inserted into
Wall Unit Base)



4 x Cam Bolts



8 x Screws SQ2



You will need:

- PZ2 Pozzi, PH2 Phillips, or SW4 hexagon socket
- SQ2 Screwdriver

Step 1

Remove the two adjustable shelves from the Wall Unit Top and lie it on its back or side. Insert four cam bolts (black end first) into the pre-drilled holes in the top of the Wall Unit Top, two at each end.

Step 2

Use two people to lift the Wall Unit Base to its final location. We recommend the unit is placed against a wall for safety reasons.

Step 3

Use two people to lift the Wall Unit Top onto the Wall Unit Base, lining up the cam bolts in the underside of the Wall Unit Top with the cam holes in the Wall Unit Base. Ensure the Top edges overhang the Wall Unit Base evenly on the front and both sides.

Step 4

Tighten cams up clockwise, do not over tighten. Fasten the Wall Unit Top to the Wall Unit Base by inserting and tightening the provided screws into the pre-drilled holes in the underside of the base unit rails.

Step 5

We recommend you secure the Wall Unit to the wall, refer to the instruction sticker on the reverse of the unit.

